

# The Woodcrest

1,824 Living Area 3 Bedroom / 2 Bath

*These drawings are for illustration purposes only. All dimensions are approximate and elevations may reflect optional features and colors. Square footage may vary by elevation.*



## Features

- Spacious Master Bedroom w/ Large Walk In Closet
- Garden Tub in Master Bath
- Family Room Great for Entertaining
- Spacious Kitchen
- Large Front Porch
- Two Car Garage Included
- Optional Bonus Room Available



*The Spruce Elevation*



*The Poplar Elevation*



*The Maple Elevation*



*The Oak Elevation*

*Visit our website or call us today to speak with a sales person.  
Toll Free: 1-877-358-9199 [www.sedgewickhomes.com](http://www.sedgewickhomes.com)*

# The Woodcrest

1,824 Living Area 3 Bedroom / 2 Bath



## Features

- Spacious Master Bedroom w/ Large Walk In Closet
- Garden Tub in Master Bath
- Family Room Great for Entertaining
- Spacious Kitchen
- Large Front Porch
- Two Car Garage Included
- Optional Bonus Room Available

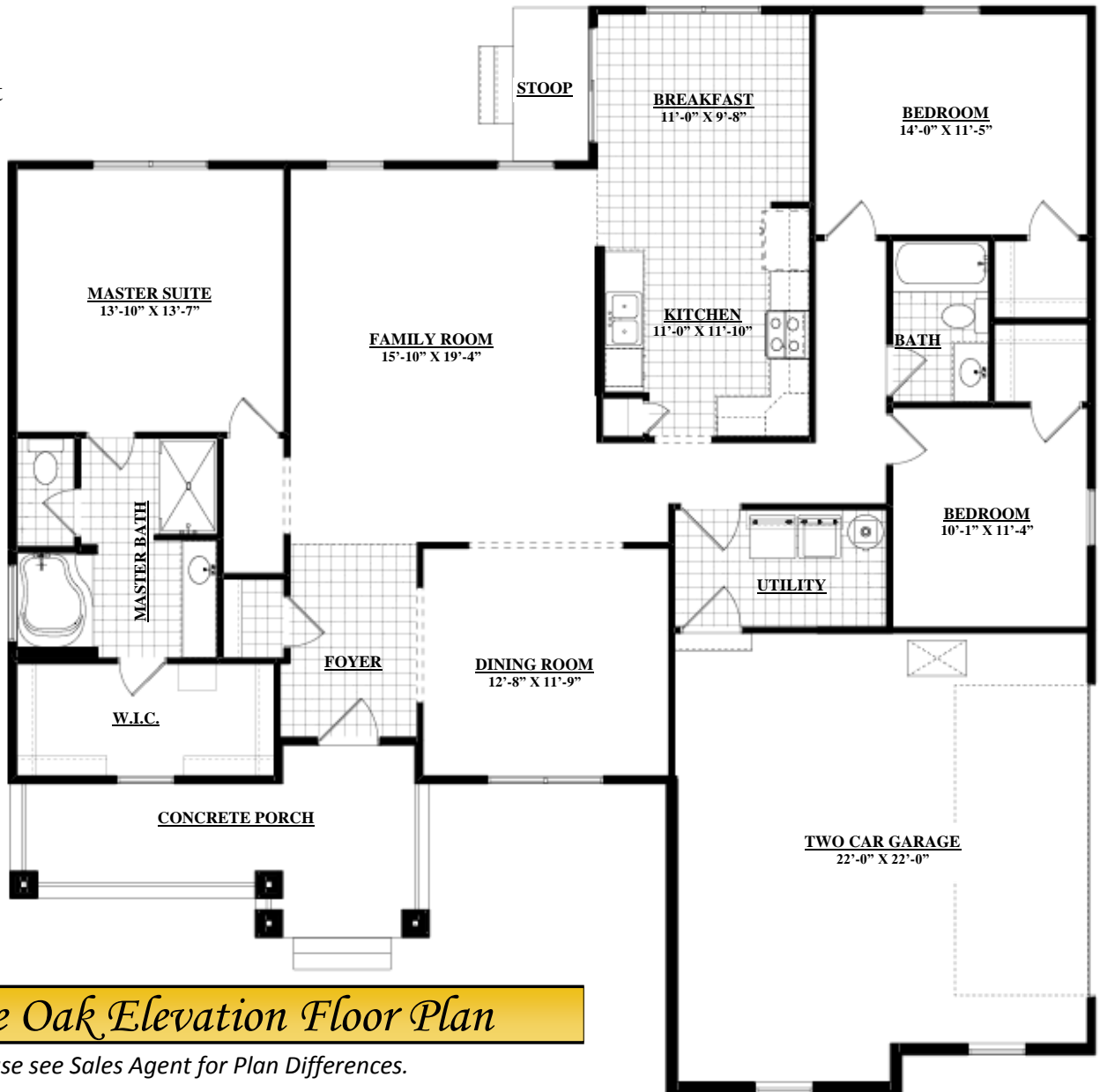

## The Oak Elevation Floor Plan

Please see Sales Agent for Plan Differences.

These drawings are for illustration purposes only. All dimensions are approximate and elevations may reflect optional features and colors. Square footage may vary by elevation.



Visit our website or call us today to speak with a sales person.  
Toll Free: 1-877-358-9199 [www.sedgewickhomes.com](http://www.sedgewickhomes.com)